

USER INSTRUCTIONS

MANUSAN

DYNAMIC FINGER ORTHOSIS



albrecht[®]
FUNKTIONELLE REHABILITATION

Contents

1. Introduction	4
1.1. Foreword	4
1.2. Customer information	4
1.3. Mode of operation	4
1.4. Application	4
1.5. Scope of delivery	4
1.6. Declaration of conformity	4
1.7. Features	4
1.8. Indications	5
1.9. Contra indications	5
1.10. Safety notes	5
1.11. Warranty	6
2. Adjustment by the orthopaedic technician	7
2.1. Fitting to the patient	7
2.1.1. Adjusting the shell components	8
2.1.2. Adjusting the hand plate	8
2.1.3. Adjusting the finger length	9
2.1.4. Tightening or loosening the rubber cord	11
2.1.5. Optional mounting of thumb component	12
2.1.6. Removing individual finger components	13
2.2. Putting on the brace	14

User Instructions

3. Cleaning, maintenance and disinfection	16
3.1. Pads and straps	16
3.2. Rods (hinges)	16
4. Technical data	17
5. Size and part numbers overview	17
6. Transfer of the brace	18
7. Disposal	18

1. Introduction

1.1. Foreword

Dynamic spring-loaded orthoses can be used to treat joint contractures caused by both neurological and orthopaedic conditions. The shortening of the tissue surrounding the joint decreases the range of motion affecting the patient's everyday life.

1.2. Customer information

For your own safety please read through these User Instructions carefully and accurately before using the brace. The instructions, notes and procedures must be read and understood thoroughly in order to benefit from the correct operation and use of the device. If anything in the User Instructions is not clear, or any instructions, operating procedures or safety information is not fully understandable, please contact the appropriate specialist retailer or albrecht GmbH directly, before you use the brace. This particularly applies to the safety instructions.

1.3. Mode of operation

The **Manusan** is used to treat an extension deficit of the finger joints.

Active use trains the appendicular finger muscles.

Passive use stimulates growth of contracted tissue due to continuous dynamic tension.

1.4. Application

The brace must only be used for the orthotic care of the hand.

1.5. Scope of delivery

After receiving the orthosis, please check it for completeness.

- Brace with pads and straps
- albrecht GmbH hexagonal screwdriver
- User Instructions
- Strap pad set
- Optional chain links

1.6. Declaration of conformity

The albrecht GmbH company, as the manufacturer solely responsible, declares that the **Manusan** conforms to the Regulation (EU) 2017/745 concerning medical devices.

1.7. Features

- Extension and flexion therapy
- Individually adjustable spring force
- Individually adjustable shell and strap system
- Easy handling and comfortable in use
- Adjustable hand plate
- No tool necessary for adjusting spring force
- Individual toolless adaptation of chains to finger length

User Instructions

1.8. Indications

The physician will prescribe the type of treatment to apply based on his or her diagnostic findings.

Generally, the use is indicated in:

- Joint contractures:
 - After surgery
 - After conservative treatment of capsular ligament injuries
 - Before and after joint replacement
 - In arthrosis and chronic polyarthritis
 - After burns
 - After strokes
 - After spinal cord injuries
 - Paralysis (discrete palsy of peripheral origin)
 - After cranio-cerebral trauma (CCT)

- Lacerations

- Tendon sutures

- Dupuytren's contracture

For all other indications a physician must be consulted.

1.9. Contra indications

- Bony obstruction, osteoporosis
thrombophlebitis

The finger brace is intended exclusively for contact with intact skin.

1.10. Safety Instructions

The optimal effect of the finger brace is only achieved when used correctly.

- The finger brace must only be used in the intact, complete and mechanically undamaged condition and with complete and intact cushioning and walers. This must be verified by the user before each usage.
- Opening or removing one or more straps, as well as excessive loosening of the waler when using the finger brace leads to a reduction of the therapeutic effect of the finger brace and may lead to injury.
- The finger brace must not be worn over open wounds.
- The skin should be free of oils, grease, gels or other debris, to prevent reactions with the skin or the structure of the material.
- The orthosis should fit firmly but not too tight, so as not to restrict the blood circulation and adversely affect nerve and lymph vessels. Excessive compression is therefore to be avoided.
- Combination with other products is currently not provided for or is to be agreed with the manufacturer in writing.
- The finger brace is not intended for single use, but is intended for multiple use by a single person.
- The product as delivered is not sterile.
- Contact your physician immediately in the event of an allergic reaction.
- Please note that cushioned sections can heat up under direct sunlight. Protect the orthosis from direct sunlight if necessary.

- Currently there is no test for flammability. Exercise caution when using the orthosis in the direct vicinity of open flames such as lighters and cigarettes.
- The mechanical functions must only be adjusted using the supplied tools in order to avoid injuries and damage of the brace
- When adjusting the hinge rods to the shape of the extremity by using an orthopaedic bending iron, you must not bend the rods in the area of the hinge housing or the hinge cover as this could lead to damage or break of the hinge.
- In case of allergic reactions, immediately contact your physician.

1.11. Warranty

We assume the warranty for the brace for a period of 3 months. The brace is a medical rehabilitation device and must not be used for any purpose other than the intended, as described in the Instructions for Use. Changes to the brace or other applications require the written consent of the albrecht GmbH. If this is not obtained, the manufacturer may not honor the guarantee. If you are using single joints or other components, these should be used as intended. If changes or modifications (e.g. additional mounting holes) are made to the individual parts or components, the manufacturer's warranty no longer applies. The removal of or damage to the QM seal will also void the warranty.

2. Adjustment by the orthopaedic technician

2.1. Fitting to the patient

- Our **Manusan** is constructed to be adjustable.
- The position of the shell components can be changed and they can be shaped.
- The hinge rods can be adapted to the shape of the extremity by using an orthopaedic bending iron.
- The strap lengths can be adjusted to different girths and shortened if necessary.

2.1.1. Adjusting the shell components

The shell elements are movable.

- 1 Loosen the screws on the shell elements with the supplied tool.
- 2 Move the shell elements to the desired position.
- 3 Tighten the screws again.

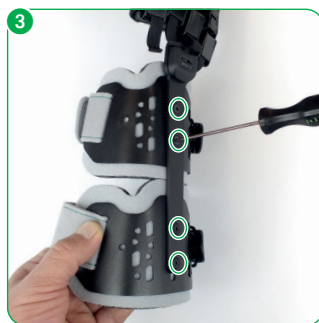
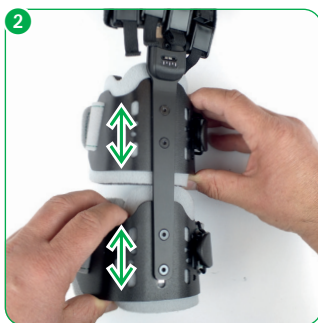
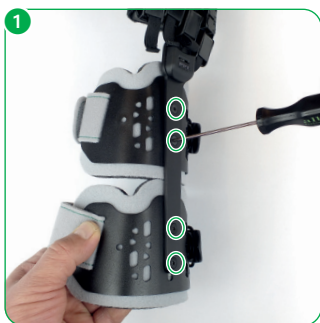

2.1.2. Adjusting the hand plate

- 1 Using the included tool, adjust the hand plate to the desired position.

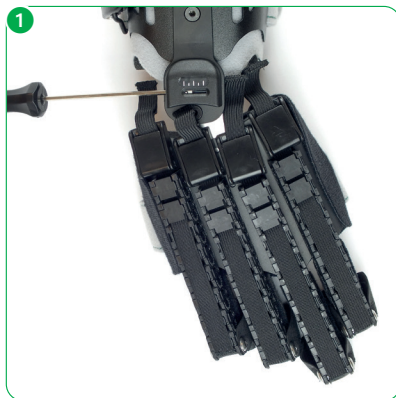
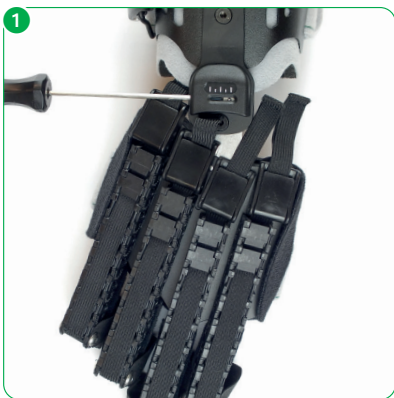

User Instructions

2.1.3. Adjusting the finger length

Caution: In order to change the finger length of the orthosis, you must first loosen the rubber cord.

- 2** Loosen the finger pad (hook-and-loop closure).
- 3** Open the toggle clamp to release the tension on the rubber cord.
- 4** Push the rubber cord to the side.
- 5** Insert the included tool between two chain links and lever it gently backward until the cover pops off. Repeat this process so that two adjacent covers are open.

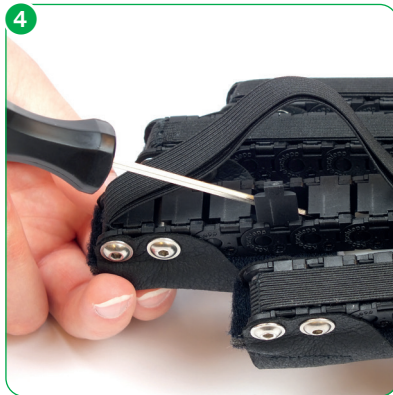
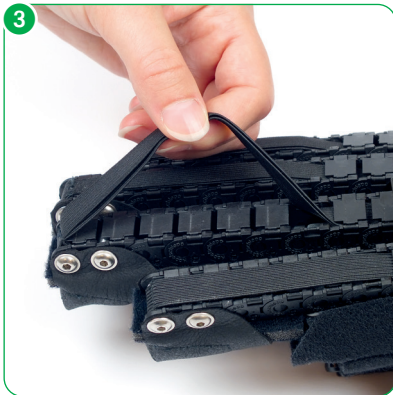
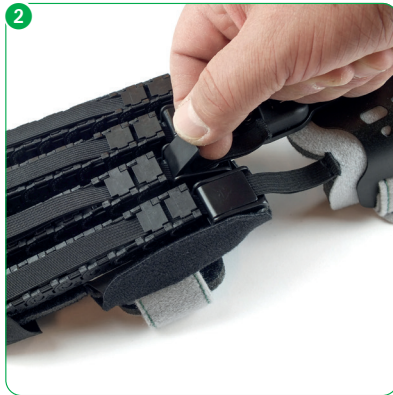

Manusan

User Instructions

- 6 Press the chain links together where the covers are open and turn them sideways. The chain is split. Now you can remove or add chain links.
- 7 When adding chain links, make sure that the open covers face upward. Each chain link changes the finger length by 13 mm. Stretch the rubber cord to the desired tension and then close the toggle clamp.
- 8 **Caution:** After adjusting the finger length, trim the finger pads so they are flush with the pad for the back of the hand.

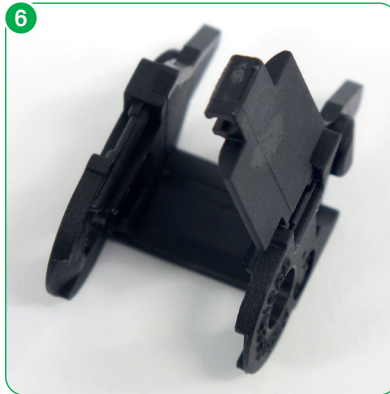

User Instructions

2.1.4. Tightening or loosening the rubber cord

- 1 Open the toggle clamp.
- 2 Stretch the rubber cord to the tension you need and then close the toggle clamp.

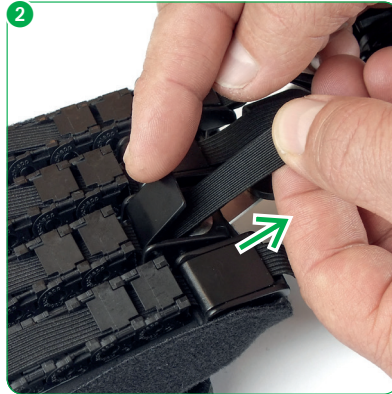
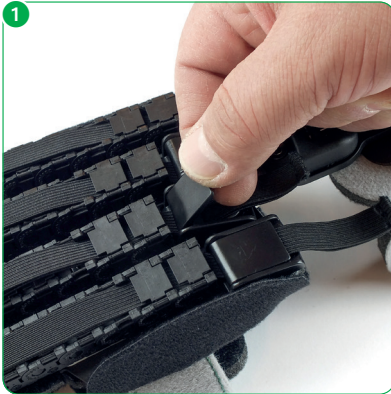

2.1.5. Optional mounting of thumb component

- 3 Remove the shell component screw near the wrist.
- 4 Using the included longer screw, mount the toggle clamp.
- 5 Thread the rubber cord through the opened toggle clamp.
- 6 Stretch the rubber cord to the tension you need and then close the toggle clamp.

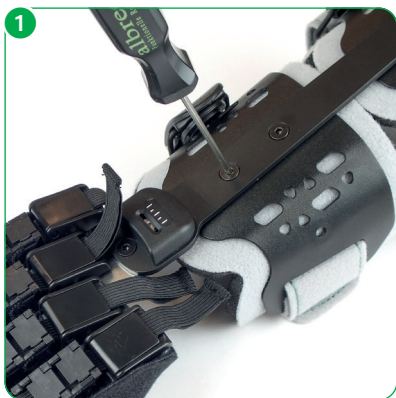

User Instructions

2.1.6. Removing individual finger components

- 1 Open the palm strap and fold aside the pad for the back of the hand.
- 2 Unscrew both screws from the finger component you want to remove and remove the slide block.
- 3 Open the toggle clamp and pull out the rubber cord with the finger component.

Remove the white Teflon strip.

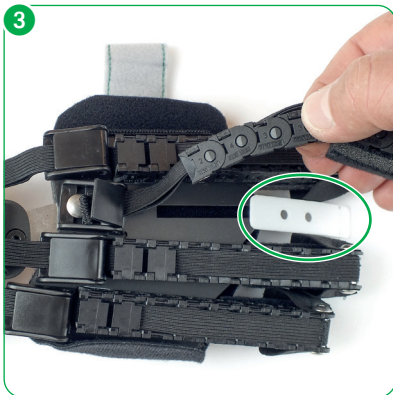

2.2. Putting on the brace

Adjust the straps to the desired lengths and shorten them if necessary.

- 1 Insert your hand through the palm strap and rest your lower arm on the orthosis. Your fingertips should reach the end of the finger cages.



User Instructions

- 2 Close the palm strap.
- 3 Close the lower arm strap near the wrist.
- 4 Close the lower arm strap further away from the wrist.
- 5 The fully fitted orthosis.





Hand wash at 30°C



Do not bleach



Do not iron



Do not dry-clean



Do not tumble dry

3. Cleaning, maintenance and disinfection

The orthosis is designed to be maintenance-free. To ensure proper operation over the period of treatment the orthosis should be cleaned regularly (at least every 3 months) or as required, according to the following instructions.

3.1. Pads and straps

- All fabrics can be washed by hand at 30°C using water and a mild detergent and/or disinfectant.
- Not machine washable.
- In the case of more severe soiling, a replacement set of textile parts is available.

3.1. Rods (hinges)

- Clean all parts of the brace with a wet cloth soaked with water and a mild detergent and/or disinfectant.
- Wipe down surfaces with a cloth soaked with disinfectant.
- Wet completely, and do not wipe off.
- Spray inaccessible surfaces.
- When spraying ensure complete wetting.
- A mild alcohol-based disinfectant is recommended.

Ask your physician or pharmacist when selecting a disinfectant, and follow the instructions given by the disinfectant manufacturer. The Robert Koch list of approved disinfectants can be found at www.rki.de.

User Instructions

4. Technical data

Name	Material
Weight	400 g
Pad material	PU foam with PA hook-and-loop fabric, partially silicone coated
Strap material	PA strap with PA hook-and-loop fabric
Brace material	Aluminium
Finger cage material	Vapor permeable microfiber PU/PA

5. Sizes and part numbers overview

Name	Wrist circumference	Hand plate width	Part no. left	Part no. right
Manusan finger orthosis L/L	22 - 30 cm	10 cm	955LL-L	955LL-R
Manusan finger orthosis M/M	18 - 24 cm	9 cm	955MM-L	955MM-R
Thump component			956	

6. Transfer of the brace

The brace is not intended for single use, but rather is intended for multiple use by a single person. We do not recommend transfer to other users. Should this be desired however, please ensure to pass on the care and cleaning instructions and have the hinge checked by an authorized specialist dealer for safe and proper operation.

7. Disposal

The brace contains recyclable materials without toxic or other harmful substances or other environmentally hazardous substances. Provided it is not contaminated with infectious germs, the hinge can be deposited in the normal waste disposal. To be sure, consult your specialist orthopaedics dealer.

Duty to report

Due to regional legal regulations, you are required to immediately report any serious incident involving the use of this medical device to the manufacturer and the responsible authorities. Please find our contact details on the back of this brochure.

User Instructions

PATENTS PENDING

VERSION: EN 01.2023



Medical device



Manufacturer



 **albrecht GmbH**

CHIAMSEESTRASSE 81
D-83233 BERNAU AM CHIAMSEE

T +49 (0)8051 96129-0

F +49 (0)8051 96129-30

INFO@ALBRECHTGMBH.COM

WWW.ALBRECHTGMBH.COM



Made in Germany
Hergestellt in Deutschland



Management
System
EN ISO
13485:2016

www.tuv.com
ID: 0000046096